

TRACT NO. 36-134

IN THE UNINCORPORATED TERRITORY OF MONO COUNTY, CALIFORNIA

BEING A RESUBDIVISION OF A PORTION OF SECTIONS 2,3,10 TOWNSHIP 4, SOUTH,
RANGE 27 EAST, M.D.B. & M. DESCRIBED IN DEED RECORDED IN BOOK 245
PAGES 83-88 OF OFFICIAL RECORDS OF SAID COUNTY.

FD. WELL MONUMENT
PER MB 9/13

FD. 2" I.P. INTERSECTION
MONUMENT FOR MEADOW LANE
AS FOUND ON RSMB 1/79

N 19° 08' 44" W 385.54' (M. PROP.)
N 19° 08' 55" W 385.51' (R. MB 9/13)
N 19° 08' 44" W 32.25' (M. PROP.)
N 19° 08' 55" W 32.25' (R. MB 9/13)

Δ=2° 01' 48"
R=4970'
L=176.09' (R 8/38)

Δ=2° 02' 01"
R=4970'
L=176.55'

FD. 2" I.P. "LS. 3246"
PER PMB 1/76

FD. L & T "LS. 3246"
PER B/38

Δ=3° 00' 00"
R=500'
L=26.18' (M&R)

Δ=3° 00' 00"
R=460'
L=24.09'

FD. 2" P.I. MONUMENT AS
FOUND IN RSMB 1/79

PMB 1/31

MB 8/38

Δ=0° 42' 48"
R=3970'
L=49.43'

Δ=0° 42' 49"
R=3970' (PER 8/38)
L=49.45'

568° 58' 01" W 226.35' (M)
568° 59' 15" W 226.46' (R 8/38)

SEE DETAIL AT LEFT
568° 58' 01" W 226.35' (M&R)

568° 58' 01" W 226.35' (M&R)
Δ=1° 53' 26"
R=5000'
L=164.98' (M&R)

Δ=1° 42' 01"
R=5040'
L=149.57'

U.S.F.S.

FD. BLM BRASS CAP
W/16
C—C
S-2
1972

LOT 4
(SHEET 4)

LOT 5
(SHEET 4)

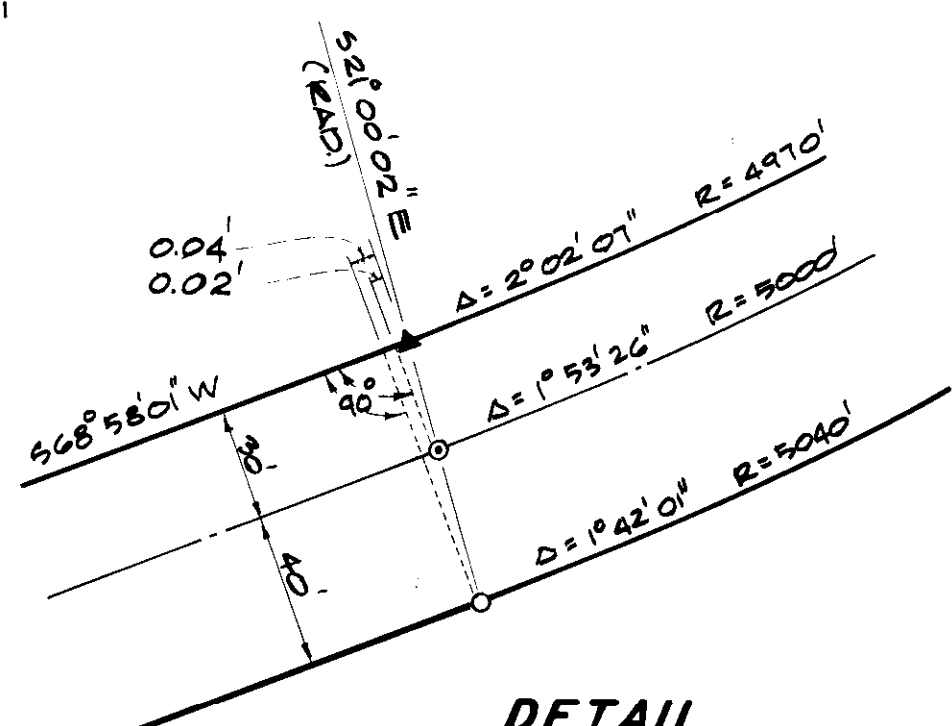

TEMPORARY ROADWAY AND
UTILITY EASEMENT FOR OLD
MAMMOTH ROAD. TO BE
RELINQUISHED UPON CONSTRUCTION
AND ACCEPTANCE OF THE
IMPROVEMENTS IN THE
NEW ROAD RIGHT-OF-WAY
SHOWN HEREON.

Δ=58° 33' 59"
R=560'
L=572.42'

Δ=58° 33' 59"
R=600'
L=613.31' (M&R)

Δ=58° 33' 59"
R=640'
L=654.19'

N 15° 16' 02" E 118.92' (M&R)

LOT 5
(SHEET 4)

LOT 4
(SHEET 4)

Δ=72° 05' 37"
R=800'
L=1006.62' (M&R)

Δ=28° 56' 09"
R=840'
L=424.22'

Δ=72° 05' 37"
R=760'
L=956.29'

N 89° 30' 15" E

545° 47' 49" E (RAD.)

LOT 7
(SHEET 7)

Δ=43° 09' 28"
R=840'
L=632.73'

SEE SHEETS 5 & 7

SEE DETAIL, SHEET 7

N 87° 21' 39" E 26.35'

MB 9/35

LOT 8
(SHEET 5)



Book 9 of Tract Maps of Page 56-E