

OWNERSHIP STATEMENT

We the undersigned, being all parties having any record title interest in the real property being subdivided, do hereby consent to the preparation and recordation of this parcel map.

As Owner:

Valencia Management, Inc., A California Corporation

Jeffrey Horne

State of California }
County of Los Angeles } ss.

On 12-05-01 before me,

Christine Blake

a Notary Public in and for said County and State, personally appeared
Jeffrey Horne

☒ personally known to me - OR - ☐ proved to me on the basis of satisfactory evidence to be the persons whose names are subscribed to the within instrument and acknowledged to me that they executed the same in their authorized capacities, and that by their signatures on the instrument the persons, or the entity upon behalf of which the persons acted, executed the instrument.

WITNESS my hand and (optional) official seal:

Notary Public (sign Christine Blake and print name)

My commission expires: 3-21-05

County of my principal place of business: Los Angeles

in lieu of seal as per
Cal. Government Code Section 66436(c)

Christine Blake
Comm # 1298245
Notary Public - California
Los Angeles County
Comm expires Mar. 21, 2005

PLANNING COMMISSION'S CERTIFICATE

This parcel map, being in accord with the approved or conditionally approved tentative parcel map, if any, is hereby approved by the Mammoth Lakes Planning Commission.

Date: Sept. 12, 2001

By: William T. Taylor
Secretary to the Planning Commission

TOWN ENGINEER'S STATEMENT

This parcel map was examined by me and the subdivision as shown is substantially the same as it appears on the tentative parcel map and any approved alterations thereof. All provisions of the Subdivision Map Act and any local ordinances applicable at the time of approval of the tentative parcel map, have been complied with.

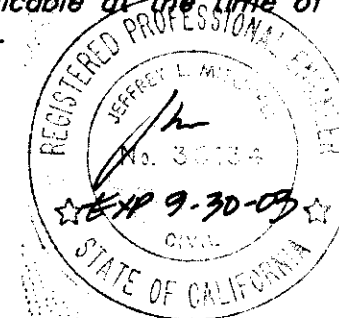

Jeffrey L. Mitchell DEC. 12, 2001
Jeffrey L. Mitchell, RCE 35134 Date
Mammoth Lakes Town Engineer
Lic. exp. 9/30/03

TOWN SURVEYOR'S STATEMENT

This final parcel map was examined by me and I am satisfied that this map is technically correct.

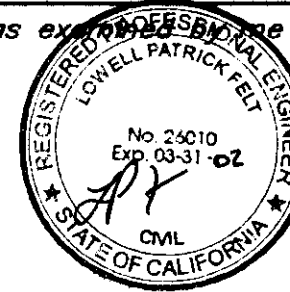

Lowell P. Felt 12-07-01
Lowell P. Felt, RCE 26010 Date
Mammoth Lakes Town Surveyor
Lic. exp. 3/31/02

TAX COLLECTOR'S CERTIFICATE

I hereby certify that, according to the records on file in this office, there are no liens against this subdivision, or any part thereof, for unpaid state, county, municipal, local taxes or special assessments collected as taxes, except taxes or special assessments not yet payable. Taxes or special assessments collected as taxes which are a lien but not yet payable are estimated to be in the amount of \$ 9,280.16 for which receipt of good and sufficient security conditioned upon payment of these taxes is hereby acknowledged.

Shirley A. Cranney
Mono County Tax Collector

12/14/01
Date

By: Luth Hansen
Deputy Mono County Tax Collector

C.C. & R.'s NOTE

The declarations of covenants, conditions, restrictions and reservations are recorded in Book NA at Page NA of Official records on file in the office of the Mono County Recorder. # 2001009084

RECORDER'S CERTIFICATE

Filed this 14th day of December, 2001, at 2:21 P.M., in Book 4 of Parcel Maps at Page 128-128A, at the request of Jeffrey Horne.

Instrument No. 2001009085 Fee: \$10.00

Renn Nolan
Mono County Recorder

By: Debra K. Wap
Deputy Mono County Recorder

SURVEYOR'S STATEMENT

This map was prepared by me or under my direction and is based upon a field survey in conformance with the requirements of the Subdivision Map Act and local ordinance at the request of Jeffrey Horne on May, 2001. I hereby state that this parcel map substantially conforms to the approved or conditionally approved tentative map, if any, and that all the monuments are of the character and occupy the positions indicated, and that such monuments are sufficient to enable the survey to be retraced.

Dec 3 2001
Date

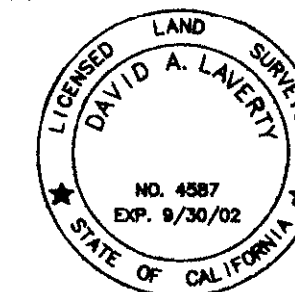

David A. Lavery L.S. 4587
Lic. exp. 9/30/02

SIGNATURE OMISSIONS

The signatures of the following companies, their successors and assigns, owners of easements as disclosed by the following deeds recorded in the Official Records of Mono County, have been omitted under the provisions of Section 66445(e) of the Subsection Map Act:

UNITED STATES OF AMERICA

VOLUME 331, PAGE 459, O.R.
DITCHES, CANALS AND
GEOTHERMAL RESOURCES

PARCEL MAP NO. 36-196

A PLANNED UNIT DEVELOPMENT
IN THE TOWN OF MAMMOTH LAKES, MONO COUNTY, CALIFORNIA

BEING A RESUBDIVISION OF PARCEL 19 OF AMENDED PARCEL MAP 36-174
RECORDED IN BOOK 4 OF PARCEL MAPS AT PAGES 101. LOCATED IN THE
OFFICE OF THE COUNTY RECORDER, MONO COUNTY, CALIFORNIA.
LOCATED IN SECTION 36, TOWNSHIP 3 SOUTH,
RANGE 27 EAST, M.D.B. & M.