

OWNERSHIP STATEMENT

We the undersigned, being all parties having any record title ownership in the real property being subdivided, do hereby consent to the preparation and recordation of this parcel map.

As owners:

[Signature]  
Michael Grant Wilson by his attorney in fact  
Michael Grant Wilson

[Signature]  
John Cree Wilson III by his attorney in fact  
John Cree Wilson, III

[Signature]  
Theresa Wilson Flynn by her attorney in fact  
Theresa Wilson Flynn

[Signature]  
Stuart O'Melveny Wilson  
Stuart O'Melveny Wilson

State of California) ss.  
County of Marin)  
On December 11, 1998 before me,  
Ali NABIPOUR  
a Notary Public in and for said County and State, personally appeared  
Stuart O'Melveny Wilson

☐ personally known to me - OR - ☒ proved to me on the basis of satisfactory evidence to be the persons whose names are subscribed to the within instrument and acknowledged to me that they executed the same in their authorized capacities, and that by their signatures on the instrument the persons, or the entity upon behalf of which the persons acted, executed the instrument.

WITNESS my hand and (optional) official seal:  
[Signature] Ali NABIPOUR  
Notary Public (sign and print name)  
My commission expires: Nov 11, 2001  
County of my principal place of business: MARIN

PLANNING COMMISSION'S CERTIFICATE

This parcel map, being in accord with the approved or conditionally approved tentative map, if any, is hereby approved by the Mammoth Lakes Planning Commission.

Date: December 18, 1998 By: William T. Taylor  
William Taylor, Secretary

TAX COLLECTOR'S CERTIFICATE

I hereby certify that, according to the records on file in this office, there are no liens against this subdivision, or any part thereof, for unpaid state, county, municipal, local taxes or special assessments collected as taxes, except taxes or special assessments not yet payable. Taxes or special assessments collected as taxes which are a lien but not yet payable are estimated to be in the amount of \$ 688.73 for which receipt of good and sufficient security conditioned upon payment of these taxes is hereby acknowledged.

Shirley A. Cranney  
Mono County Tax Collector

12-30-98  
Date

By: Betty Wilmet  
Deputy Mono County Tax Collector

SIGNATURE OMISSIONS

The signatures of the following companies, their successors and assigns, owners of easements or intrests as disclosed by the following deeds recorded in the Official Records of Mono County, have been omitted under the provisions of Section 66436 Subsection a-3Ai of the Subdivision Map Act:

California Interstate Telephone Company 97/570 O.R. recorded 11-1-68  
Southern California Edison Company 97/570 O.R. recorded 11-1-68

SURVEYOR'S STATEMENT

This map was prepared by me or under my direction and is based upon a field survey in conformance with the requirements of the Subdivision Map Act and local ordinance at the request of Stuart Wilson in November, 1998. I hereby state that this parcel map substantially conforms to the approved or conditionally approved tentative map, if any, and that all the monuments are of the character and are set in the positions indicated, and that such monuments are sufficient to enable the survey to be retraced.

December 14 1998  
Date

[Signature]  
David A. Laverty L.S. 4587  
Lic. exp. 9/30/02

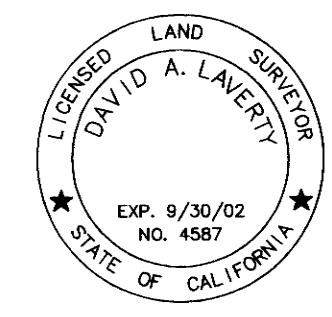

RECORDER'S CERTIFICATE

Filed this 30th day of December, 1998 at 1:11 P.M., in Book 4 of Parcel Maps at Page 109-109A, at the request of Stuart O'Melveny Wilson.

Instrument No. #9056 Fee: \$10.00

Renn Nolan  
Mono County Recorder

By: [Signature]  
Deputy Mono County Recorder

TOWN ENGINEER'S STATEMENT

This Parcel Map was examined by me and the subdivision as shown is substantially the same as it appears on the Tentative Parcel Map and any alterations thereof. All provisions of the Subdivision Map Act and any local ordinances applicable at the time of approval of the Tentative Parcel Map have been complied with.

Town Engineer:

12/28/98  
Date

[Signature]  
Jeffrey L. Mitchell RCE 35134  
Mammoth Lakes Town Engineer  
License expires 09/30/99

TOWN SURVEYOR'S STATEMENT

This Parcel Map was examined by me and I am satisfied that this map is technically correct.

Town Surveyor:

12/23/98  
Date

[Signature]  
Craig Tackabery PLS 7128  
Mammoth Lakes Town Surveyor  
License expires 12/31/02



PARCEL MAP NO. 36-187

IN THE TOWN OF MAMMOTH LAKES, MONO COUNTY, CALIFORNIA

BEING A SUBDIVISION OF THE PARCEL DESCRIBED IN THE GRANT DEED RECORDED JANUARY 3, 1977 IN VOLUME 215 PAGE 48 IN THE OFFICE OF THE COUNTY RECORDER, MONO COUNTY, CALIFORNIA AND ALSO SHOWN AS SUBJECT PARCEL OF RECORD OF SURVEY RECORDED IN MAP BOOK 6 PAGE 31 IN SAID COUNTY