

OUTSIDE CORNER DETAIL 3

Scale= 3" = 1'-0" A-104

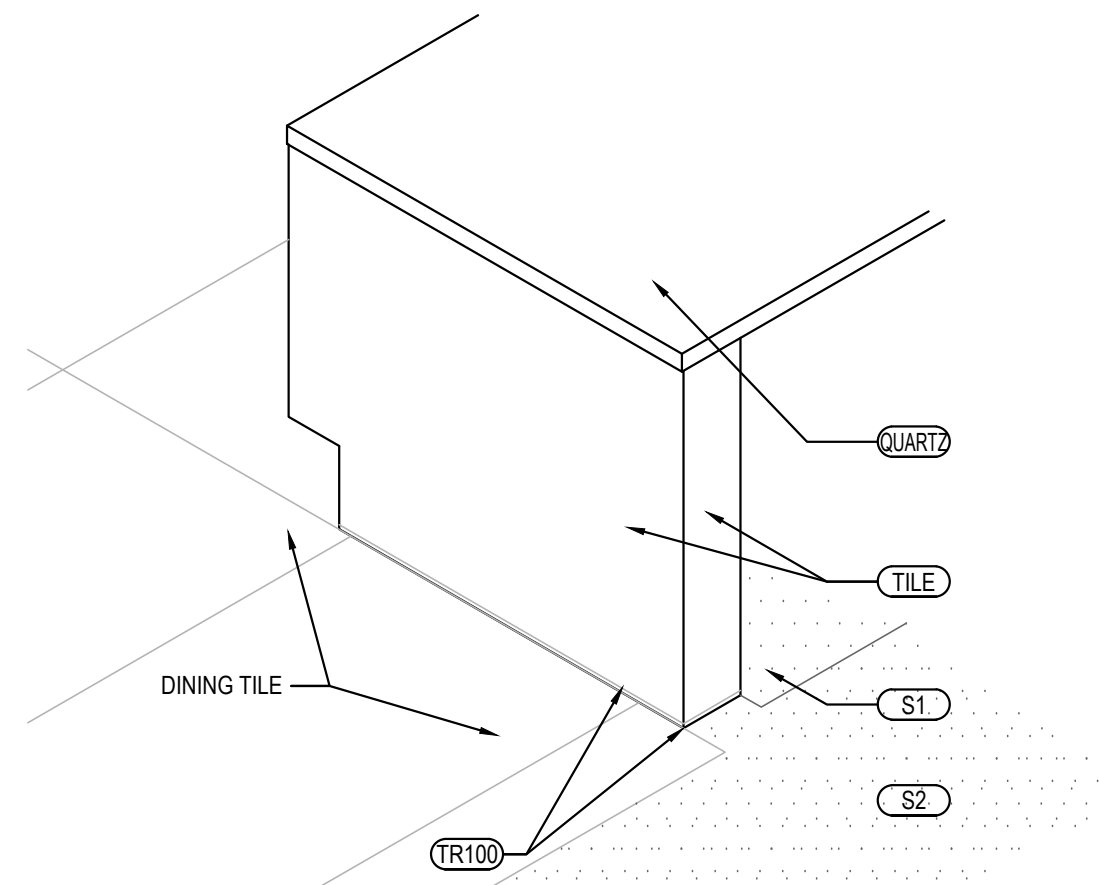

SERVICE COUNTER ISOMETRIC 2

Scale= 3/4" = 1'-0" A-104

TILE SCHEDULE

INSTALLED AND FURNISHED BY G.C. UNLESS NOTED OTHERWISE

01-11-19

NO.	MANUFACTURER	DESCRIPTION	COLOR	FINISH	JOINT	GROUT	REMARK
(T-108)	CMC AGGREGATE DOUG SALATINO 518-713-5371	12" X 24" X 3/8"	-	-	1/8"	G-111	RESTROOM WALL
(T-109)	DALTILE	6" X 36" X 3/8" 9" X 36" X 3/8"	FOREST PARK SUGARMAPLE FP969	-	1/8"	G-114	RR VESTIBULE & DINING ROOM WALLS CONTACT: NATIONAL ACCOUNT SUPPORT DESK 877.556.5728 (national.accounts@daltile.com)
(T-200)	CMC DOUG SALATINO 518-713-5371	24" X 24"	BRAVADA GREIGE	MATTE	1/8"	G-96	DINING & RESTROOM FLOOR
(T-300)	DALTILE	WHEEL LATTICE WEAVE	BLACK	MATTE	1/8"	G-113	BEVERAGE COUNTER BACKSPLASH AND SERVICE COUNTER
(S1)	SILIKAL	QUARTZ BLEND #4	-	PLAIN	-	-	KITCHEN, SERVICE FLOOR CONTACT: MARK FELDMAN 770-830-1404 (mfeldman@silikalamerica.com)
(S2)	SILIKAL	QUARTZ BLEND #4	-	ABRASIVE	-	-	JOHN COOTHRAN 688-830-1404 (jcothran@silikalamerica.com)
(M100)	MATSINC 800.628.7462	NUWAY - 7/16" ALUM FOOT GRILLE	CHARCOAL	-	-	-	(2) 2' X 6' PIECES FOR A 4' X 6' OVERALL MAT SIZE IN VESTIBULE @ VESTIBULE STORES
GROUT	MANUFACTURER	DESCRIPTION	MFG.	COLOR	FINISH	REMARK	
(G-96)	MAPEI 800.42.MAPEI WWW.MAPEI.COM	LATEX MODIFIED GROUT	11	SAHARA BEIGE	POLY BLEND 1/8" NON-SANDED	DINING & RESTROOM FLOOR APPLY GROUT SEALER	
(G-111)	MAPEI 800.42.MAPEI WWW.MAPEI.COM	LATEX MODIFIED GROUT	19	PEARL GREY	POLY BLEND 1/8" NON-SANDED	RESTROOM, DINING APPLY GROUT SEALER	
(G-113)	MAPEI 800.42.MAPEI WWW.MAPEI.COM	LATEX MODIFIED GROUT	07	CHOCOLATE	POLY BLEND 1/8" NON-SANDED	APPLY GROUT SEALER	
(G-114)	MAPEI 800.42.MAPEI WWW.MAPEI.COM	LATEX MODIFIED GROUT	19	PEARL GREY	POLY BLEND 1/8" NON-SANDED	BEVERAGE COUNTER BACKSPLASH APPLY GROUT SEALER	

* REFER A-200 EXTERIOR FINISH SCHEDULE FOR EXTERIOR DECORATIVE TILE

* SCHLUTER SYSTEM ALUMINUM TRIM:

COVE TILE TRIM: INSTALLED AT RESTROOM, SERVICE COUNTER, AND DRINK STATION
SCHLUTER SYSTEMS DILEX-AHK 1S 125 ATGB (BRUSHED NICKEL ANODIZED ALUMINUM)
-OUTSIDE CORNER CONNECTOR PIECE: DILEX-AHK-E90/AHK 1S 125 ATGB (BRUSHED
NICKEL ANODIZED ALUMINUM)
-INSIDE CORNER CONNECTOR PIECE: DILEX-AHK-I90/AHK 1S 125 ATGB (BRUSHED
NICKEL ANODIZED ALUMINUM)
-END CAP PIECE: DILEX-AHK-E/AHK 1S 125 ATGB (BRUSHED NICKEL ANODIZED
ALUMINUM)

EDGE TILE TRIM:

SCHLUTER SYSTEMS RONDEC-RO125 ATGB (BRUSHED NICKEL ANODIZED ALUMINUM)
-OUTSIDE CORNER CONNECTOR PIECE: RONDEC-EVRO125 ATGB (BRUSHED NICKEL
ANODIZED ALUMINUM)
-INSIDE CORNER CONNECTOR PIECE: RONDEC-I2L/RO125 ATGB (BRUSHED NICKEL
ANODIZED ALUMINUM)

SCHLUTER SYSTEMS RONDEC-RO80 ATGB (BRUSHED NICKEL ANODIZED ALUMINUM)
-OUTSIDE CORNER CONNECTOR PIECE: RONDEC-EVRO180 ATGB (BRUSHED NICKEL
ANODIZED ALUMINUM)
-INSIDE CORNER CONNECTOR PIECE: RONDEC-I2L/RO80 ATGB (BRUSHED NICKEL
ANODIZED ALUMINUM)

SCHLUTER SYSTEMS JOLLY-A 80 ATGB (BRUSHED NICKEL ANODIZED ALUMINUM)
-OUTSIDE EDGE PROTECTION PIECE

FLOOR TILE TRANSITION TRIM: INSTALLED IN VESTIBULE
SCHLUTER SYSTEMS SCHIENE-RAE125 (SATIN ANODIZED ALUMINUM)

(TR102)

* EPOXY GROUT BY MAPEI, KERAPPOXY IEG, 100% SOLIDS INDUSTRIAL GRADE:
AREAS UNDER HOOD AND 36" IN FRONT OF COOKING LINE, 3 COMPARTMENT SINK AND MOP SINK AREA

SEE MANUFACTURER'S SPECIFICATION, DETAILS AND GUIDE FOR PREPARATION,
MIXING, GROUTING AND CLEANING INSTRUCTION
NOTE: SEE INTERIOR SHEETS FOR WALL/ BASE TILE LOCATIONS AND
SPECIFICATIONS

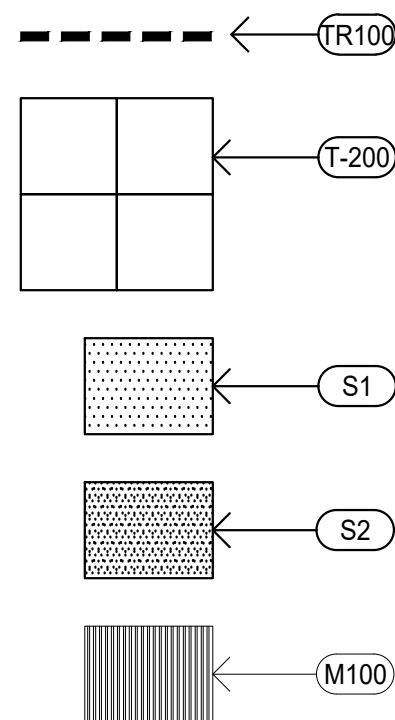

FINISH SCHEDULE A

Scale= NTS A-104

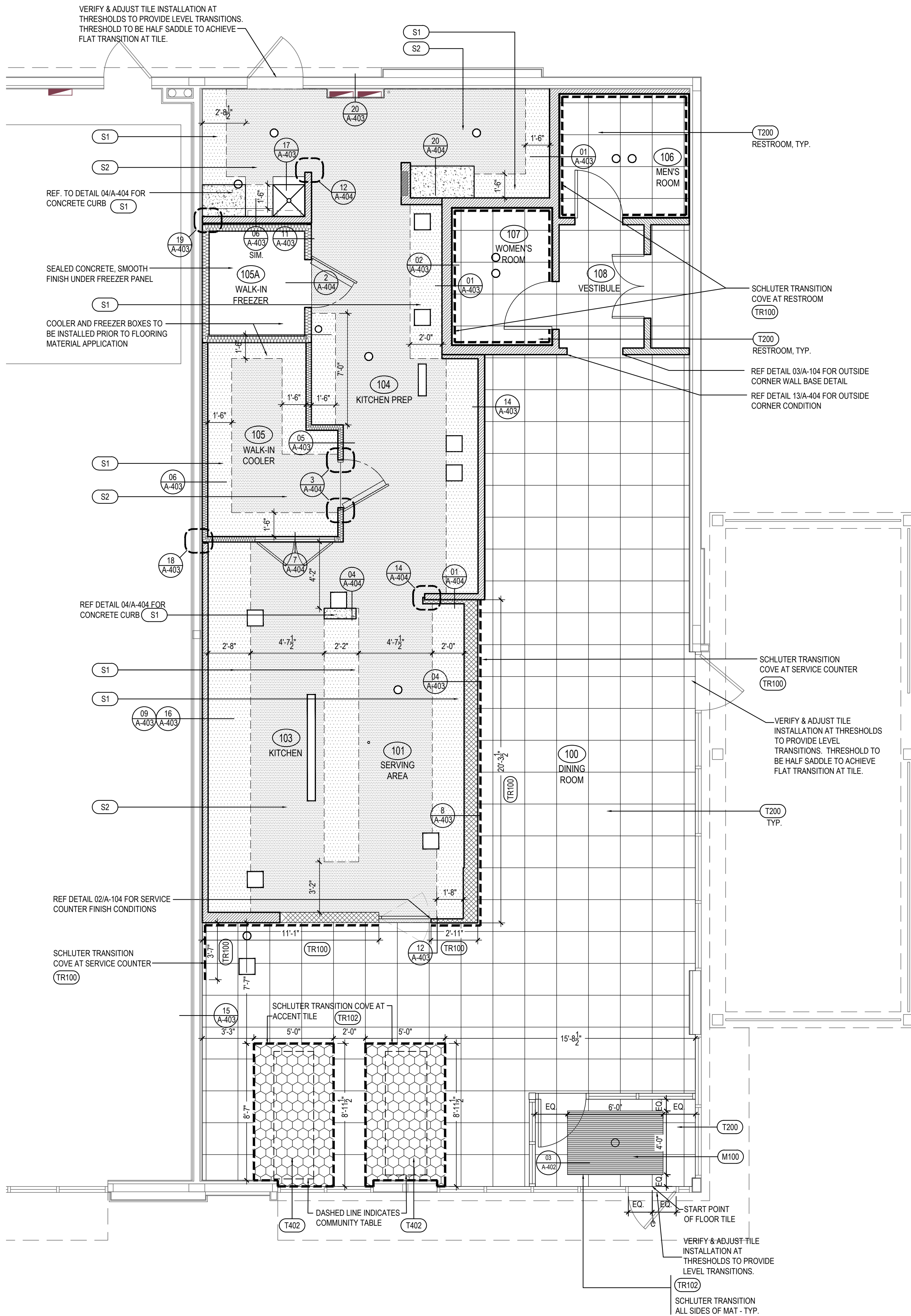

FINISH PLAN 1

Scale= 1/4" = 1'-0" A-104



PANDA EXPRESS, INC.
1683 Walnut Grove Ave.
Rosemead, California
91770

Telephone: 626.799.9898
Facsimile: 626.372.8288

All ideas, designs, arrangement and plans indicated or
represented by this drawing are the property of Panda
Express Inc. and were created for use on this specific project.
None of these ideas, designs, arrangements or plans may be
used by or disclosed to any person, firm, or corporation
without the written permission of Panda Express Inc.

REVISIONS:

ISSUE DATE:

LANDLORD REVIEW	03-04-2022
FINAL LANDLORD REV.	06-20-2022
PERMIT	07-19-2022
BID SET	10-06-2022
CONSTRUCTION SET	01-16-2023

DRAWN BY: TD

PANDA PROJECT #: D7861
ARCH PROJECT #: JCDT21-0268

I certify that these documents were prepared or approved by me, and that I am a
duly licensed architect/engineer under the laws of the State of Maryland, license
number 20249, expiration date 2/10/2024.

NORR
ARCHITECTS ENGINEERS PLANNERS

PANDA EXPRESS

TRUE WARM & WELCOME
10300 Mill Run Circle
Owings Mills, MD 21117

A-104

FINISH PLAN AND SCHEDULE

TRUE WARM & WELCOME 2300 R6 RR

CONSTRUCTION SET

01-16-2023