

PROFILE of BASSOM AVE.

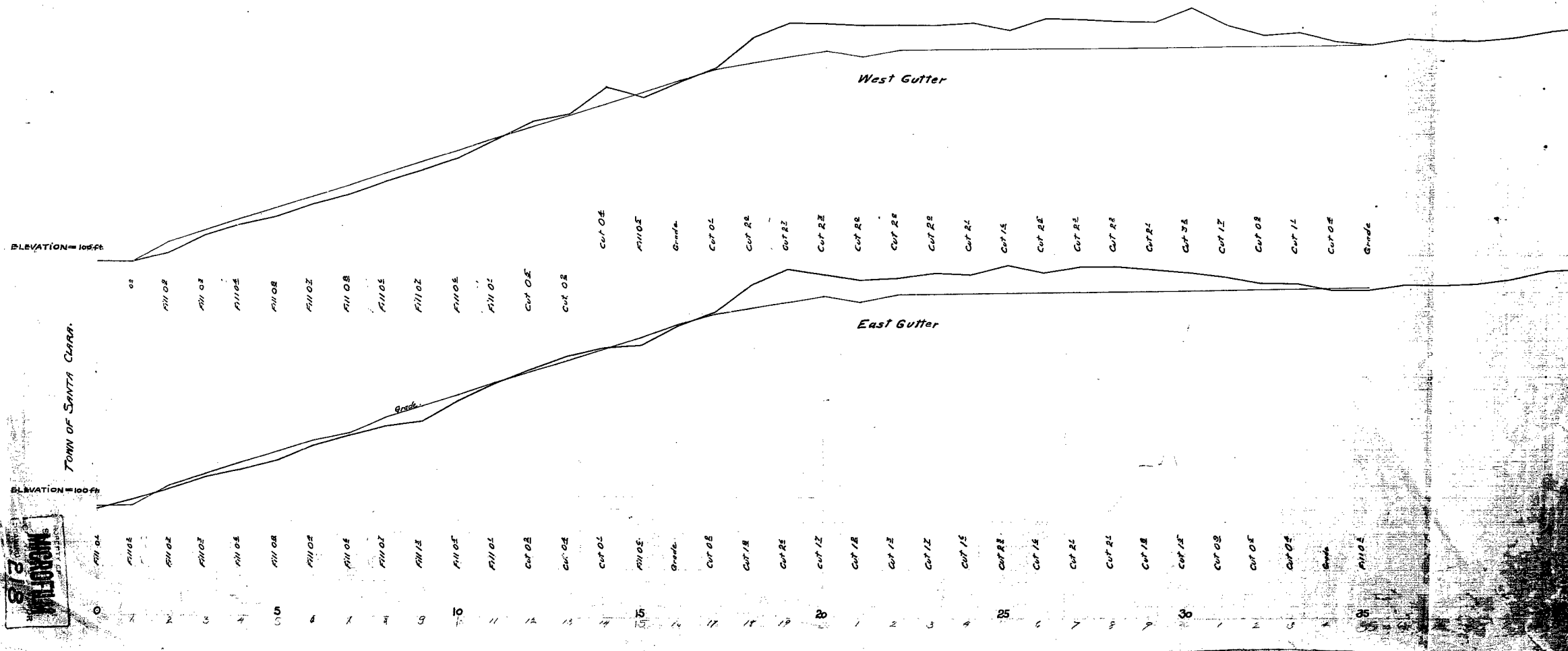

PROPERTY OF
MICROFILM
SERIALS
218

ELEVATION
OF
OLD & PRESENT CHANNELS
OF
COYOTE CREEK ON STORY ROAD

98
Elev. Bridge Floor.

96

94

92

90

88

86
High E. Bank

84

82

80
West Bank Old Channel

78
Sand Bank Between the Channels

76

74
Lower East Bank

72
Bottom Old Channel

70
Creek Bed Present Channel

68

PROPERTY OF
SANTA CLAY CO.
COUNTY ENGINEER
219

0 20 40 60 80 100 120 140 160 180 200 220 240 260 280 300 320 340 360 380 400

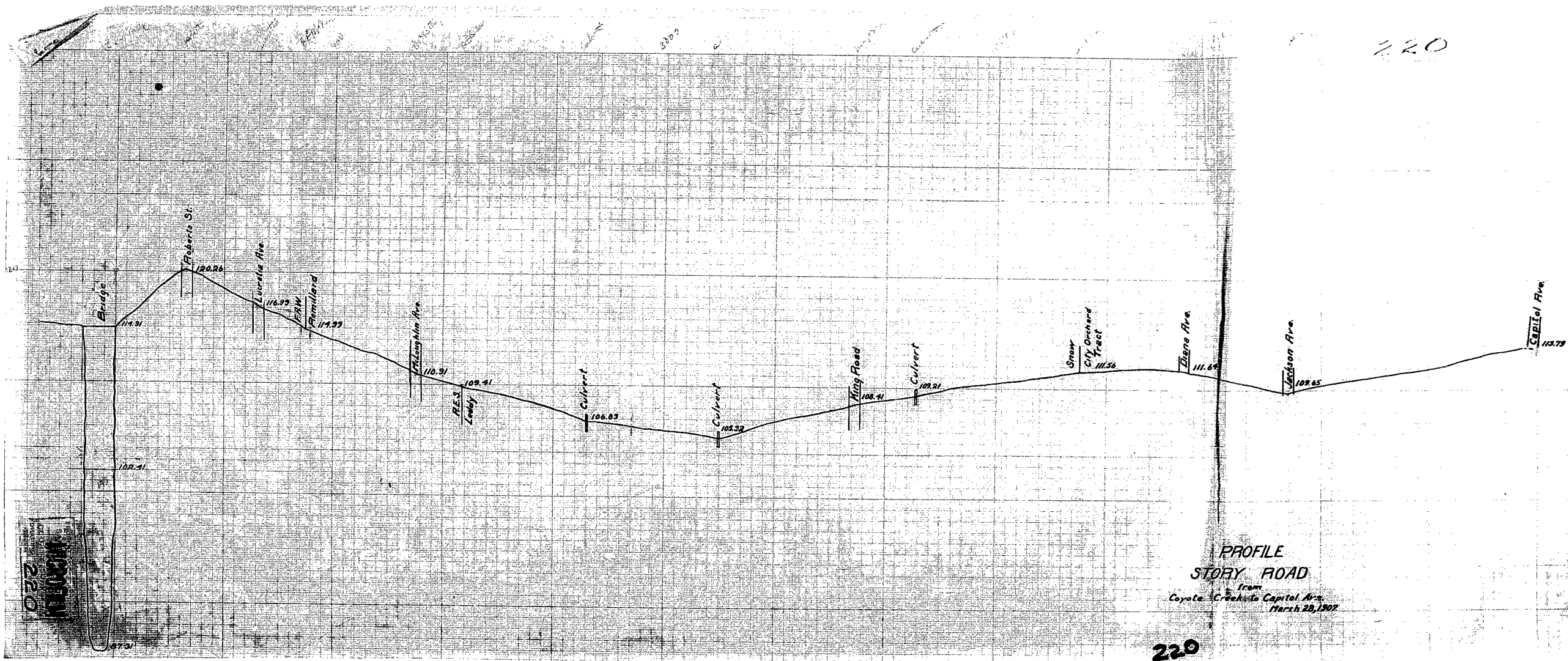

220

220

25000-Gal. Tank.

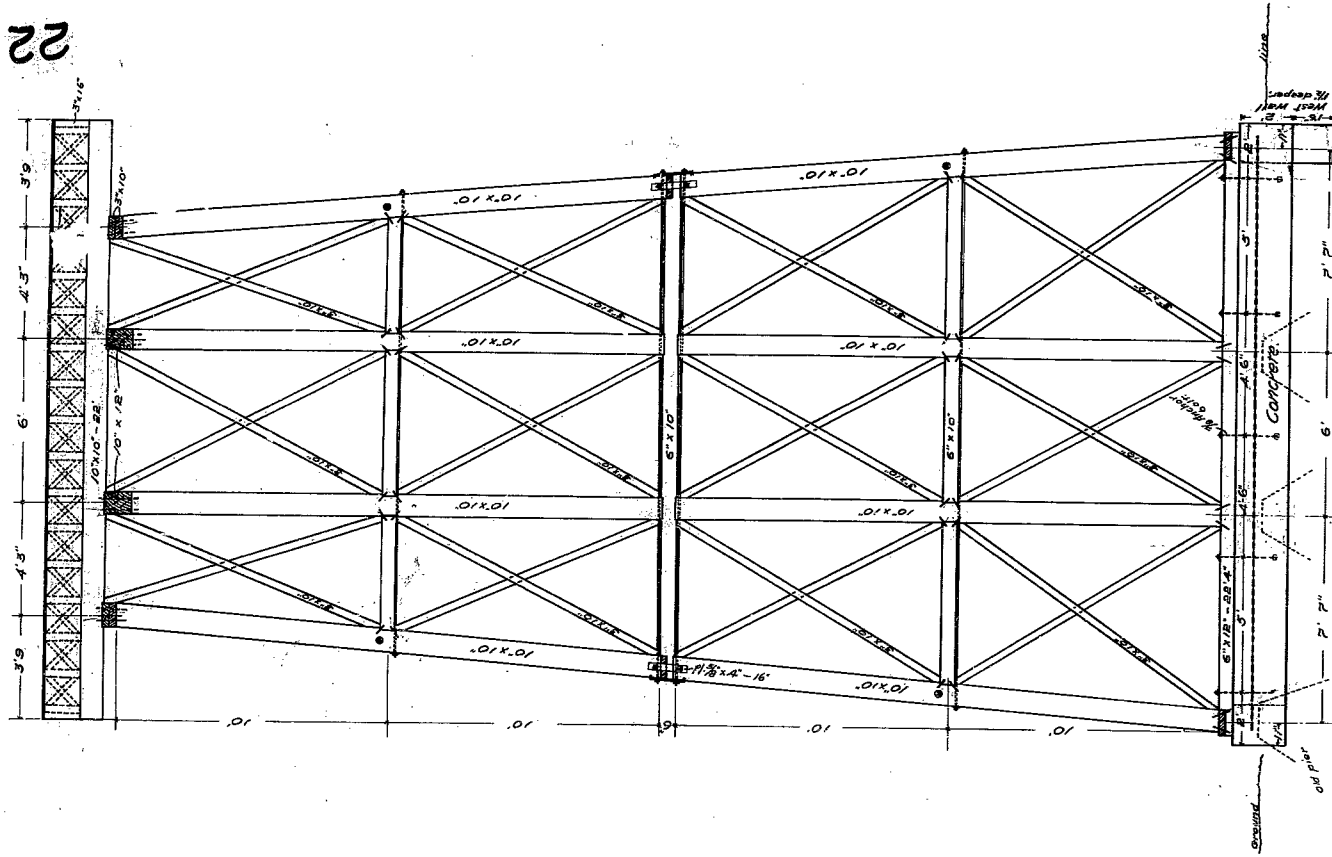
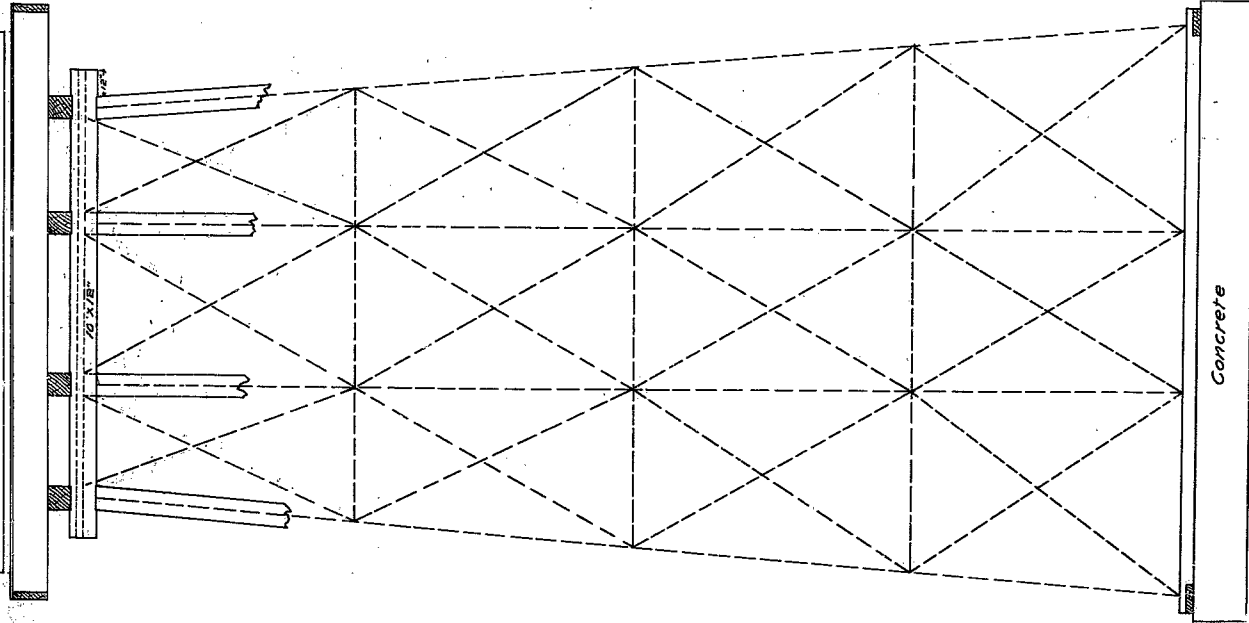

WOODEN TOWER
 for
 WATER TANK ON THE SAN FRANCISCO ROAD
 Between Sunnyvale & Mountain View.
 May 1906.
 Scale: 1/8" = 1'-0"
 J. G. McMillan, Co. Surveyor.

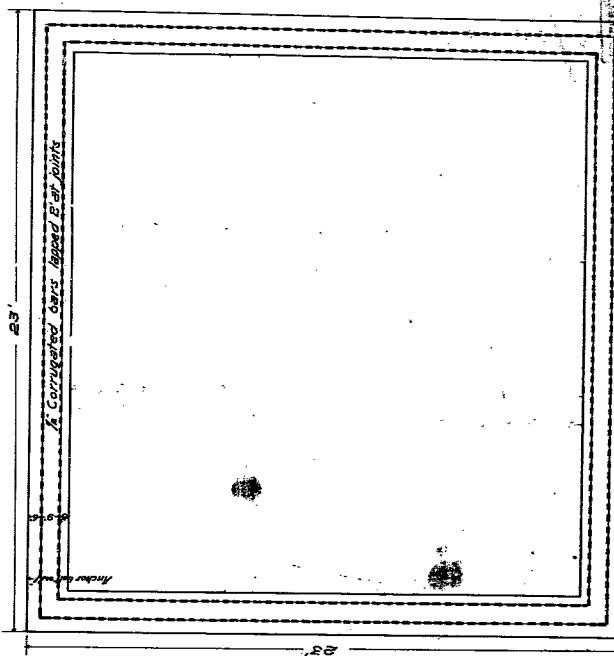

MICROFILM
 221

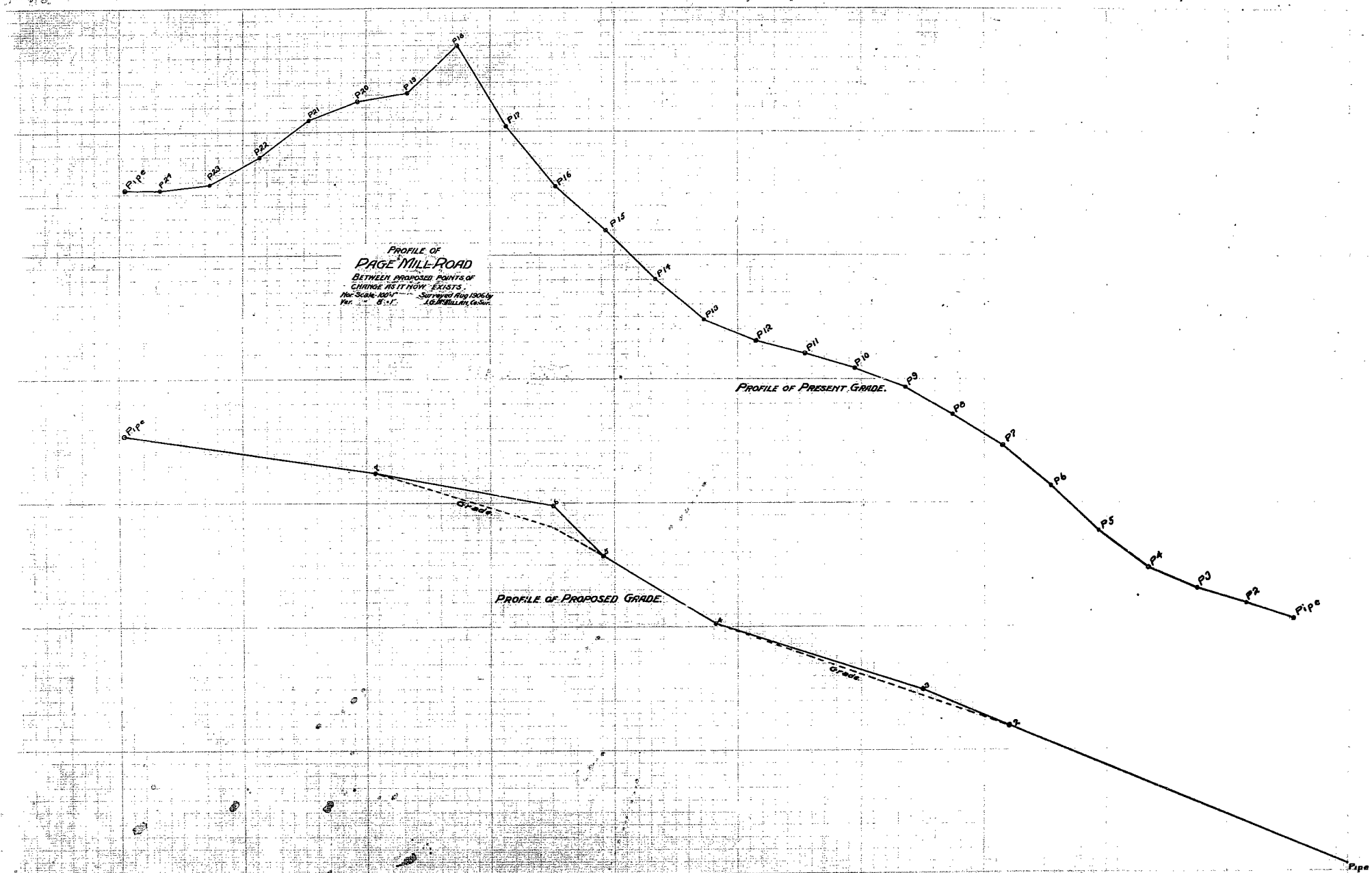

253
MICROFILM

223

PROFILE
OF
PAGE MILL ROAD
From Sta. 0 at Bridge Northerly to Sta 25 on top of First Hill.
Scale; Hor. 50' = 1" Ver. 6' = 1"
Surveyed Mar. 1906 by J.G. McMillan, Co. Surveyor

Note: Averages are for 1 foot of width.

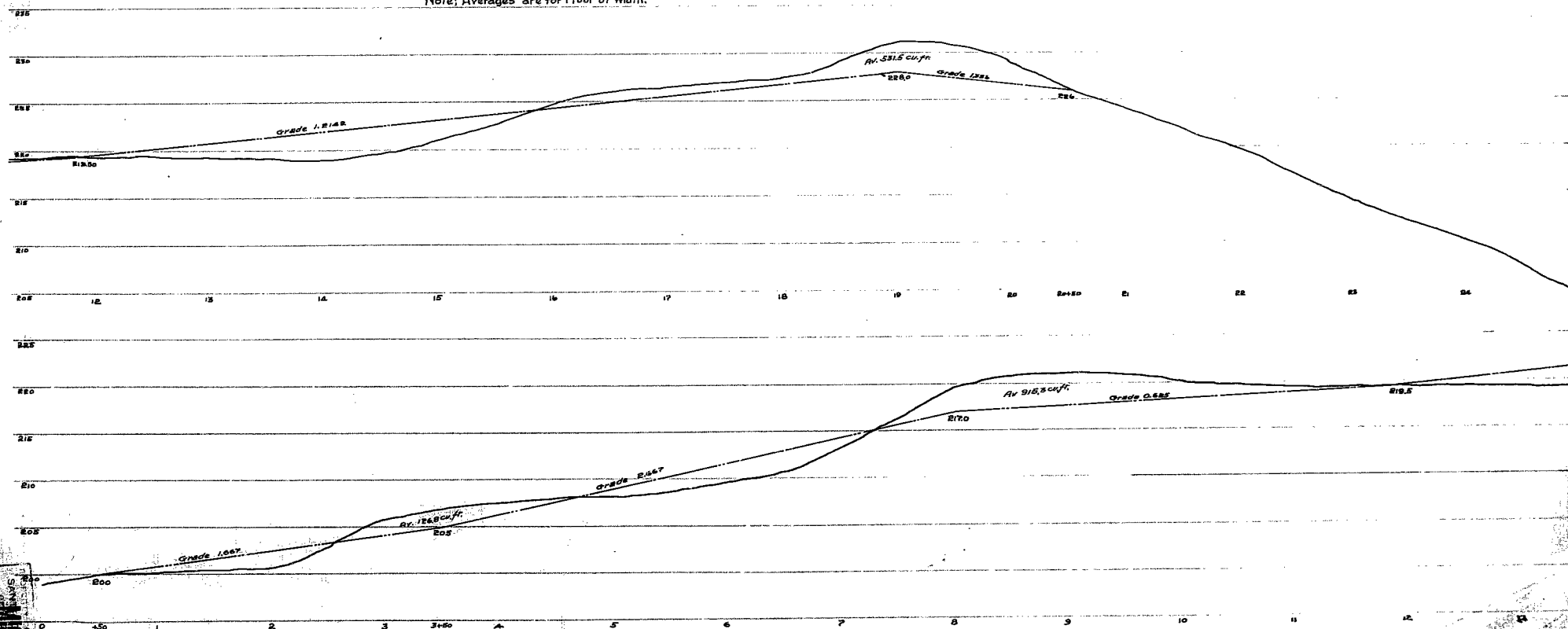

223

223