

CORNER RECORD

Agency Index

BK 122 PG 52

Document Number

CR 11901

City of EDEN TOWNSHIP

County of ALAMEDA, California

Brief Legal Description BRASS DISC MONUMENT LOCATED WITHIN BUCKEYE DR

CORNER TYPE

COORDINATES (Optional)

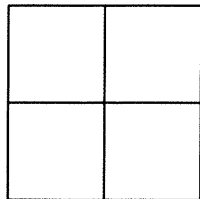

Government Corner ☐ Control ☒
Meander ☐ Property ☐
Rancho ☐ Other ☐

Date of Survey 6/7/18

N. _____ E. _____

Elevation _____

Units Metric ☐ U.S. Survey Foot ☐

Horizontal Datum _____

Zone _____ Epoch Date _____

Vertical Datum _____

☐ Complies with Public Resources Code §§8801-8819☐ Complies with Public Resources Code §§8890-8902PLS Act Ref: ☐ 8765(d) ☒ 8771 ☐ 8773 ☐ Other:

Corner/Monument: ☒ Left as found ☐ Established ☐ Rebuilt ☐ Pre-Construction
☐ Found and tagged ☐ Reestablished ☐ Referenced ☒ Post-Construction

Narrative of corner identified and monument as found, set, reset, replaced, or removed:

☐ See sheet #2 for description(s) : SEE CR 11270

FOUND BRASS DISC MONUMENT WITH PUNCH IN CONCRETE IN MONUMENT WELL STAMPED LS 5077.

FOUND AND SET POINTS AS SHOWN ON PAGE 2.

THIS POINT WAS FOUND IN GOOD CONDITION AFTER A CONSTRUCTION PROJECT IN THE VICINITY.
THE TIES SHOWN HEREON ARE FOR THE PURPOSE OF PERPETUATING FOUND MONUMENTATION.
NO CLAIM IS MADE AS TO THE RELATIONSHIP OF THE POINTS OR LINES SHOWN HEREON TO TRUE
BOUNDARY LOCATION.

SURVEYOR'S STATEMENT

This Corner Record was prepared by me or under my direction in conformance with

the Professional Land Surveyors' Act on JUNE 22, 2018.

Signed Scott V. Cunha P.L.S. or R.C.E. No. LS 8525
SCOTT V. CUNHA

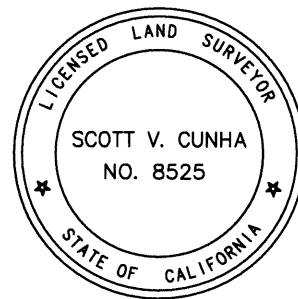

COUNTY SURVEYOR'S STATEMENT

This Corner Record was received 24 July 2018

and examined and filed 17 July 2019.

Signed Michael Rubner P.L.S. or R.C.E. No. 6843

Title COUNTY SURVEYOR

County Surveyor's Comment

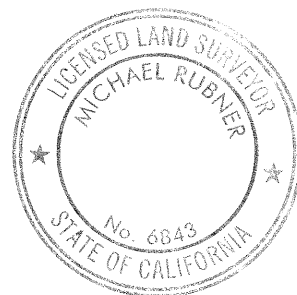

SPEC-2353-Post

LEGEND

- FOUND BRASS DISC WITH PUNCH IN CONCRETE IN MONUMENT WELL
STAMPED LS 5077
⊗ FOUND CUT CROSS IN WALK
✕ FOUND CUT CROSS IN CURB
⊗ FOUND MAG AND SHINER
○ FOUND REBAR & CAP STAMPED "CEI RP"
AA##A# ALAMEDA COUNTY MONUMENT ID
19592 REFERENCE STREET ADDRESS

SCALE: 1"=30'

