

NOTES and LEGEND

- DENOTES 3/4" REBAR WITH PLASTIC CAP STAMPED PLS 3570 SET ON THIS SURVEY
- DENOTES FOUND 3/4" REBAR TAGGED LS 3725 PER 49-M-91 AND 5-SUBS-99
- DENOTES FOUND 3/4" REBAR TAGGED LS 3570 PER 46-M-30 AND/OR 49-M-91
- DENOTES FOUND 5/8" REBAR TAGGED LS 3570 PER 46-M-30 AND/OR 36-M-15
- DENOTES A CALCULATED POINT ONLY, NOTHING FOUND OR SET
- ( ) DENOTES RECORD DATA PER 49-M-91 AND/OR 46-M-30
- ( )<sup>a</sup> DENOTES RECORD DATA PER 1998001749
- ( )<sup>b</sup> DENOTES RECORD DATA PER 2000000721
- PUE DENOTES PUBLIC UTILITY EASEMENT
- CL DENOTES CENTERLINE OR DISTANCE TO CENTERLINE
- RW DENOTES RIGHT-OF-WAY OR DISTANCE TO RIGHT-OF-WAY
- BSL DENOTES BUILDING SETBACK LINE

RECORD of SURVEY  
BOUNDARY LINE ADJUSTMENT

for  
D'ARCY A. PORTER and MICHELLE Y. PORTER  
Trustees of the  
Porter Family Trust dated July 14, 2003  
20050001193

and  
MICHELLE Y. PORTER  
Trustee of the  
Rovai Family Trust udt dated January 16, 2003  
20030004321 and 20140000793

BEING A PORTION OF THE NE AND SE 1/4 SECTION 36, T. 7 N., R. 11 E., M. D. M.  
COUNTY OF AMADOR, STATE OF CALIFORNIA

Scale: 1"=100'

February, 2014

**TOMA & ASSOCIATES INC.**  
ENGINEERING - SURVEYING - PLANNING  
41 Summit Street, Jackson, CA 95642  
(209) 223-0156

SURVEYOR'S STATEMENT

THIS MAP CORRECTLY REPRESENTS A SURVEY MADE BY ME OR UNDER MY DIRECTION IN CONFORMANCE WITH THE REQUIREMENTS OF THE PROFESSIONAL LAND SURVEYORS ACT AT THE REQUEST OF D'ARCY PORTER IN DECEMBER OF 2013.  
DATE: MARCH 4, 2014

*Ciro L. Toma*  
CIRO L. TOMA P.L.S. 3570  
MY LICENSE EXPIRES 6-30-2014

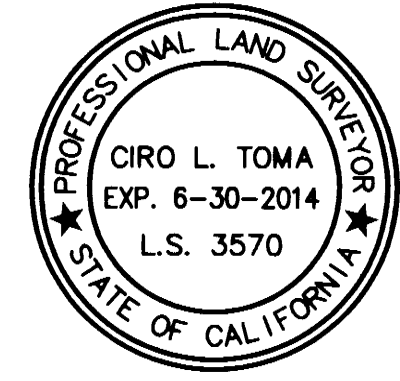

COUNTY SURVEYOR'S STATEMENT

THIS MAP HAS BEEN EXAMINED IN ACCORDANCE WITH SECTION 8766 OF THE PROFESSIONAL LAND SURVEYORS ACT THIS 17<sup>TH</sup> DAY OF JUNE, 2014.

*George E. Allen*  
GEORGE E. ALLEN L.S. 4951  
AMADOR COUNTY SURVEYOR  
MY LICENSE EXPIRES 12-31-2015



COMPLIANCE CERTIFICATE

THIS BOUNDARY LINE ADJUSTMENT IS IN COMPLIANCE WITH THE PROVISIONS OF THE SUBDIVISION MAP ACT, DIVISION 2 OF TITLE 7 OF THE GOVERNMENT CODE, AND ANY APPLICABLE ORDINANCE ENACTED PURSUANT THERETO.

THIS ADJUSTMENT MUST BE COMPLETED IN ALL ASPECTS BY THE 28<sup>th</sup> DAY OF FEBRUARY, 2015. THE EXCHANGE OF DEEDS OR COMPLIANCE CERTIFICATES MUST BE RECORDED BEFORE THE ABOVE DATE PER ORDINANCE No. 1445, CHAPTER 17.89 OF THE AMADOR COUNTY CODE.

DATE: JUNE 11, 2014

*George E. Allen*  
GEORGE E. ALLEN L.S. 4951  
AMADOR COUNTY SURVEYOR  
MY LICENSE EXPIRES 12-31-2015



RECORDER'S STATEMENT

FILED THIS 16<sup>th</sup> DAY OF JUNE, 2014 AT 9:03 A.M.  
IN BOOK 64 OF MAPS AND PLATS AT PAGE 4 AT THE REQUEST OF  
THE AMADOR COUNTY SURVEYOR.

FEE: \$10<sup>00</sup> pd. filed

INSTRUMENT No.: 2014-0003866

*Kimberly L. Grady*  
KIMBERLY L. GRADY BY: \_\_\_\_\_  
AMADOR COUNTY RECORDER DEPUTY

OWNER'S STATEMENT

THE UNDERSIGNED, BEING THE OWNERS OF THE PROPERTY DELINEATED HEREON, DO HEREBY CONSENT TO THE PREPARATION AND RECORDATION OF THIS MAP.

*D'Arcy A. Porter*  
D'ARCY A. PORTER, Trustee of the  
Porter Family Trust dated July 14, 2003

*Michelle Y. Porter*  
MICHELLE Y. PORTER, Trustee of the  
Porter Family Trust dated July 14, 2003

*Michelle Y. Porter*  
MICHELLE Y. PORTER, Trustee of the  
Rovai Family Trust udt dated  
January 16, 2003

