

LEGEND

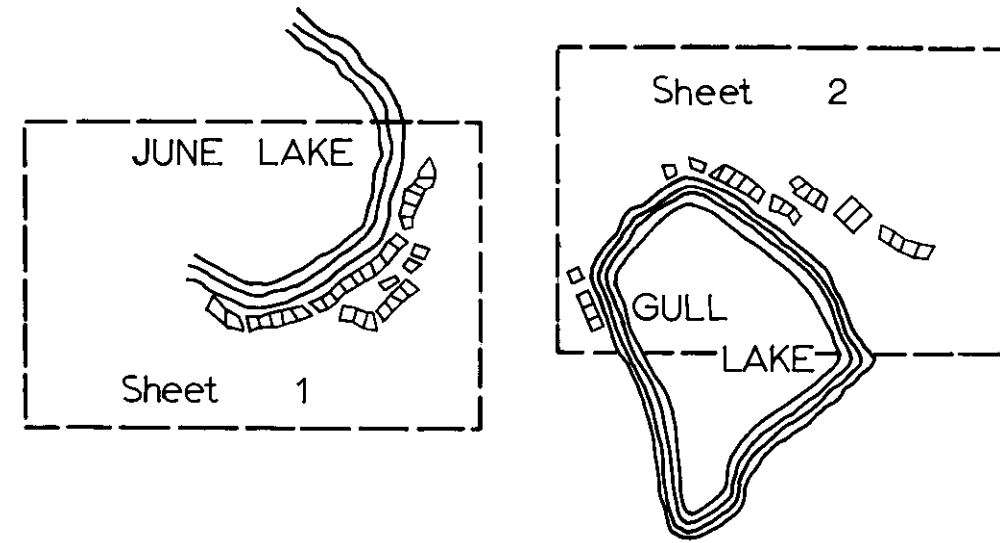
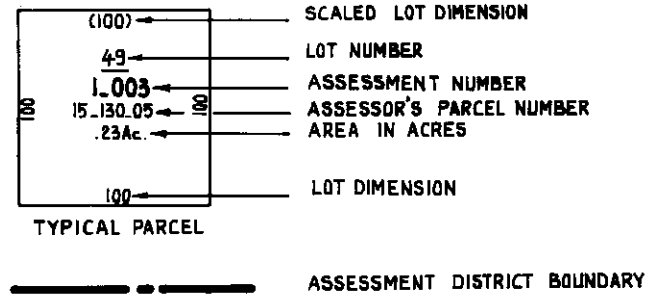

LOCATION MAP
Not To Scale

FILED IN THE OFFICE OF THE COUNTY CLERK OF THE COUNTY OF MONO, STATE OF CALIFORNIA, THIS 9th DAY OF March, 1976.

Ann M. Webb
ANN M. WEBB
COUNTY CLERK
COUNTY OF MONO
STATE OF CALIFORNIA.

I HEREBY CERTIFY THAT THE WITHIN MAP SHOWING AMENDED PROPOSED BOUNDARIES OF MONO COUNTY, JUNE LAKE ASSESSMENT DISTRICT NO. 4, MONO COUNTY, STATE OF CALIFORNIA, WAS APPROVED BY THE BOARD OF SUPERVISORS OF THE COUNTY OF MONO AT A REGULAR MEETING THEREOF, HELD ON THE 9th DAY OF March, 1976 BY ITS RESOLUTION NO. 26-28

Ann M. Webb
ANN M. WEBB
COUNTY CLERK
COUNTY OF MONO
STATE OF CALIFORNIA.

No. 4010

FILED THIS 24th DAY OF March, 1976 AT THE HOUR OF 3:46 O'CLOCK P.M. IN BOOK 1 OF MAPS OF ASSESSMENT DISTRICTS AT PAGE 12 IN THE OFFICE OF THE COUNTY RECORDER OF THE COUNTY OF MONO, STATE OF CALIFORNIA. *12-A

Ann M. Webb
ANN M. WEBB
COUNTY RECORDER
COUNTY OF MONO
STATE OF CALIFORNIA.

THIS AMENDS THE MAP SHOWING PROPOSED BOUNDARIES OF MONO COUNTY, JUNE LAKE ASSESSMENT DISTRICT NO. 4, MONO COUNTY, STATE OF CALIFORNIA, PRIOR RECORDED THE 3RD DAY OF JULY, 1974, AT THE HOUR OF 11:00 CLOCK A.M. IN BOOK 1, OF MAPS OF ASSESSMENT DISTRICTS AT PAGE 7.7.C IN THE OFFICE OF THE COUNTY RECORDER OF THE COUNTY OF MONO, STATE OF CALIFORNIA.

