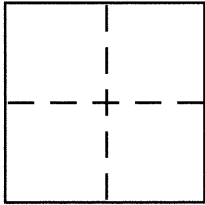

**CORNER RECORD**Document Number CR 8114City of San LeandroCounty of Alameda, CaliforniaBrief Legal Description Monument @ Robin St & Fir Avenue**CORNER TYPE**

Government Corner ☐ Control ☒  
 Meander ☐ Property ☐  
 Rancho ☐ Other ☐  
 Date of Survey Feb 13 2016

**COORDINATES (Optional)**

N. 2083699.538  
 E. 6690972.9130  
 Zone 5 NAD27 ☐ NAD83 ☒  
 NAD83 Epoch \_\_\_\_\_  
 Elev. \_\_\_\_\_  
 Vert. Datum: NGVD29 ☐ NAVD88 ☐  
 Meas. Units: Metric ☐ Imperial ☒

Corner – Left as found ☒ Found and tagged ☐ Established ☐ Reestablished ☐ Rebuilt ☐

Identification and type of corner found: Evidence used to identify or procedure used to establish or reestablish the corner:

Per section 8771.6 of the Business and Professions Code  
This monument was referenced prior to a construction project in the vicinity

A description of the physical condition of the monument as found and as set or reset:

Found in good condition

**SURVEYOR'S STATEMENT**

This Corner Record was prepared by me or under my direction in conformance with the Land Surveyor's Act on Feb 16 2016

Signed Joseph Brajkovich P.L.S. or R.C.E. No. 5254

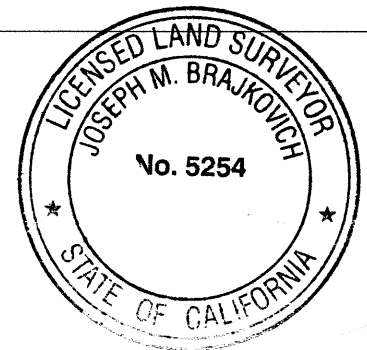
**COUNTY SURVEYOR'S STATEMENT**

This Corner Record was received 25 FEBRUARY, 2016

and examined and filed 18 MARCH, 2016

Signed Michael Rubner P.L.S. or R.C.E. No. 6843

Title COUNTY SURVEYOR

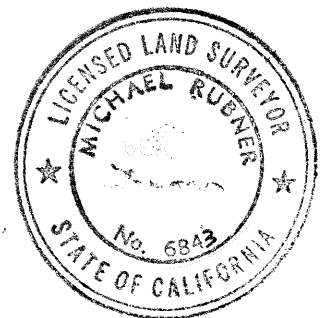

County Surveyor's Comment \_\_\_\_\_

REF.  
NORTH  
1"=10'

ROBIN STREET

FIR AVENUE

MONUMENT

S74°28'39"E  
49.07

S27°12'58"E  
42.47

N70°51'44"W  
28.21

LEGEND

- MONUMENT
- CUT X